

**Zmluva o dodaní tovarov podľa ustanovenia § 269 ods. 2 zákona č. 513/1991 Zb. Obchodný zákonník v znení neskorších predpisov**

**“Dodanie bezdrôtových prístupových bodov na verejných priestranstvách v rámci obce Trebostovo“**

**I. Zmluvné strany**

Objednávateľ: Obec Trebostovo  
Adresa: Hlavná 113, 038 41 Trebostovo  
V zastúpení: Ivan Trimaj, starosta obce Trebostovo  
Bankové spojenie: Prima banka Slovensko, a.s.  
Číslo účtu/IBAN: SK925600000003002033002  
IČO: 00316954

Zhotoviteľ: GAYA, s.r.o.  
Adresa: P.O.Hviezdoslava 23B, 036 01 Martin  
V zastúpení: Mgr. Peter Moric, konateľ  
Ing. Richard Galčík, konateľ  
Bankové spojenie: Tatra banka , pobočka Martin  
Číslo účtu: SK47 1100 0000 0026 2102 6958  
IČO: 36430307  
IČ DPH: SK2022003863

**II. Predmet zmluvy**

Zhotoviteľ sa zaväzuje vykonať za podmienok uvedených v tejto zmluve pre objednávateľa: Wifi systém obce v rámci projektu „Dodanie bezdrôtových prístupových bodov na verejných priestranstvách v rámci obce Trebostovo.“, podľa cenovej ponuky „Dodanie bezdrôtových prístupových bodov na verejných priestranstvách v rámci obce“. Súčasťou dodania tovaru je aj dodanie materiálu na jeho vykonanie, ako aj vykonanie skúšok jeho funkčnosti a spísanie protokolu o skúškach, t.j. projektová dokumentácia, ktorá bude obsahovať sieťové zapojenie aktívnych prvkov siete s IP adresným plánom, simuláciou pokrytia priestoru, meranie skutočného pokrytia, technické listy aktívnych prvkov, funkčný popis a vyobrazenie obsahu hotspot portálu s umiestneným logom. Vybudovaná WiFi sieť bude používať označenie siete (SSID) WiFi pre Teba a poskytovať internetovú konektivitu s minimálnou rýchlosťou sťahovania 30 Mbps.

**III. Termín plnenia**

Najneskôr do 12 mesiacov odo dňa nadobudnutia účinnosti zmluvy v zmysle čl. XI. Záverečné ustanovenie bod 2, odovzdaním diela objednávateľovi.

**IV. Miesto plnenia / realizácie predmetu zmluvy**

Miestom dodania t.j. miesto realizácie predmetu zmluvy je Obec Trebostovo, Hlavná 113, 038 41 Trebostovo.

#### V. Dohodnutá cena

Cena bez DPH:	5000,00 €
DPH 20%:	1000,00 €
Cena celkom:	6000,00 €

#### VI. Platobné podmienky, fakturačné podmienky a sankcie

1. Predmet obstarávania bude realizovaný bez preddavkov a platba bude zhotoviteľovi poukázaná na základe vykonaných prác po odovzdaní tovaru a ukončení prác. Odovzdanie tovarov obe strany potvrdia podpísaním protokolu o odovzdaní predmetu plnenia. Protokol o odovzdaní a prevzatí zmluvné strany podpíšu po úspešnom vykonaní skúšky funkčnosti vybudovaného WiFi systému.
2. Dohodnutá cena v rozsahu uvedenom v článku V. tejto zmluvy, bude zhotoviteľovi uhradená na účet v plnej výške, a to najneskôr do 15 dní od pripísania finančných prostriedkov z platobnej jednotky MF SR na účet objednávateľa.
3. V prípade, ak objednávateľ neuhradí dohodnutú a fakturovanú cenu v lehote splatnosti faktúry, je zhotoviteľ od prvého dňa omeškania oprávnený požadovať od kupujúceho úrok z omeškania vo výške 0,05% za každý deň omeškania.
4. Prílohou faktúry bude súpis vykonaných prác a dodávok.
5. V cene predmetu zmluvy sú zahrnuté všetky práce a dodávky požadované podmienkami a podkladmi na výber zhotoviteľa.
6. Objednávateľ si vyhradzuje právo neprevziať predmet obstarávania od zhotoviteľa v prípade, že nebude zrealizovaný v dohodnutom rozsahu.
7. V prípade omeškania s plnením predmetu obstarávania zo strany zhotoviteľa, si objednávateľ môže uplatniť nárok na úhradu zmluvnej pokuty vo výške 0,05 % z omeškanej ceny bez DPH, za každý deň omeškania zo strany zhotoviteľa.
8. V prípade nedodržania stanoveného termínu na odstránenie chýb zhotoviteľom, má objednávateľ právo pozdržať platbu za vykonané práce po dobu odstránenia chýb, pričom vzniknuté náklady bude znášať zhotoviteľ.
9. Faktúra – daňový doklad musí obsahovať všetky náležitosti stanovené platnými právnymi predpismi. Prílohou faktúry budú rozpísané všetky nákladové položky na každý typ Access Point (prístupový bod - AP) zvlášť.
10. Objednávateľ je oprávnený kontrolovať vykonávanie diela a upozorňovať dodávateľa na vady vzniknuté chybným vykonávaním diela.
11. Objednávateľ sa zaväzuje informovať dodávateľa bez zbytočného odkladu o všetkých skutočnostiach potrebných pre činnosť dodávateľa a včas mu oznamovať všetky zmeny a dôležité okolnosti, ktoré môžu mať vplyv na jeho činnosť podľa zmluvy.

## VII. Povinnosti zhotoviteľa

1. Zhotoviteľ sa zaväzuje poskytnúť tovary v zmysle dohodnutých podmienok a platných predpisov.
2. Zhotoviteľ zodpovedá za to, že pri realizácii diela sa nepoužije materiál, o ktorom je v dobe zabudovania známe, že je škodlivý.
3. Zhotoviteľ zodpovedá za individuálnu bezpečnosť svojich pracovníkov a ich vybavenie ochrannými pomôckami podľa predpisov BOZP. Zhotoviteľ je pri odovzdávaní predmetu obstarania povinný predložiť objednávateľovi certifikáty od použitých materiálov a zariadení a protokol o skúškach funkčnosti.
4. Zhotoviteľ je počas záručnej doby povinný po písomnom oznámení objednávateľa reagovať na prípadné reklamované (skryté) chyby, a to do 3 dní od obdržania oznámenia.
5. V prípade, že zhotoviteľ neodstráni vady reklamované v záručnej lehote, je objednávateľ oprávnený nechať tieto vady odstrániť treťou osobou a náklady vyúčtovať zhotoviteľovi. Zhotoviteľ sa zaväzuje tieto náklady uhradiť v plnej výške do 21 kalendárnych dní odo dňa obdržania faktúry, ktorou mu boli tieto náklady vyúčtované.
6. Zhotoviteľ sa zaväzuje udržiavať na stavenisku poriadok.
7. Zhotoviteľ zodpovedá za dodržanie bezpečnostných predpisov a požiarnej ochrany, zodpovedá za prípadné škody na majetku vzniknuté pri výkone prác.
8. Zhotoviteľ zabezpečí zneškodnenie všetkých vzniknutých odpadov v súlade so zákonom č. 223/2001 Zb. o odpadoch, u oprávnených poskytovateľov takejto služby.
9. Zhotoviteľ sa zaväzuje vykonať úkony, ktoré sú predmetom tejto zmluvy na základe technických požiadaviek podľa Výzvy na predkladanie ponúk „Dodanie bezdrôtových prístupových bodov na verejných priestranstvách v rámci obce“.
10. Zhotoviteľ je povinný bez meškania informovať objednávateľa o vzniku akejkoľvek udalosti, ktorá bráni alebo sťažuje realizáciu predmetu diela s dôsledkom predĺženia času plnenia.
11. Prístupové body, ktoré budú umiestnené na uvedených verejných priestranstvách musia spĺňať minimálne nasledujúce technické parametre:
  - a. Kompaktné dvojpásmové WiFi zariadenia (2,4 GHz – 5 GHz), ktoré sú certifikované pre európsky trh.
  - b. Životný cyklus použitých produktov vyšší ako 5 rokov.
  - c. Stredná doba medzi poruchami (MTBF) minimálne 5 rokov.
  - d. Možnosť centrálného manažmentu pre riadenie, monitoring a konfiguráciu siete (single point of management).
  - e. Súlad s „802.11ac Wave 1, Institute of Electrical and Electronics Engineers“ (IEEE) štandardom.

- f. Podpora 802.1x IEEE štandardu.
- g. Podpora 802.11r IEEE štandardu.
- h. Podpora 802.11k IEEE štandardu.
- i. Podpora 802.11v IEEE štandardu.
- j. Schopnosť AP obsluhovať naraz aspoň 50 rôznych užívateľov bez zníženia kvality služby.
- k. Minimálne 2x2 MIMO (multiple-input-multiple-output).
- l. Súlad s Hotspot 2.0 (Passpoint WiFi Alliance certification program).

12. Prístupové body budú umiestnené:

- 1. Materská škola (49,02584114 ; 18,86564434)
- 2. Futbalové ihrisko (49,02662907 ; 18,86011362)
- 3. Rodinný dom (49,02413598 ; 18,85812074)
- 4. Obecný úrad (49,02409553 ; 18,85787666)

#### **VIII. Povinnosti objednávateľa**

- 1. Objednávateľ výkony prác, uvedených v článku II tejto zmluvy, preberie na základe preberacieho protokolu.
- 2. Objednávateľ sa zaväzuje sprístupniť priestory zhotoviteľovi pre účely vyhotovenia projektu.
- 3. Objednávateľ je oprávnený bez akýchkoľvek sankcií odstúpiť od zmluvy s dodávateľom/zhotoviteľom v prípade, kedy ešte nedošlo k plneniu zo zmluvy medzi žiadateľom/prijímateľom a dodávateľom/zhotoviteľom a výsledky kontroly riadiaceho orgánu (RO) neumožňujú financovanie výdavkov vzniknutých z verejného obstarávania, ktoré bolo/je predmetom kontroly zo strany RO v plnom rozsahu.

#### **IX. Všeobecné dodacie podmienky**

- 1. Záručná doba, týkajúca sa poskytnutých tovarov, začína plynúť dňom podpísania Protokolu o odovzdaní a prevzatí zodpovednými zástupcami zmluvných strán a je 24 mesiacov.
- 2. Zhotoviteľ nezodpovedá za prípadné poškodenia treťou osobou po jeho odovzdaní.
- 3. Objednávateľ sa zaväzuje v prípade zistenia väd diela písomne oznámiť bez zbytočného odkladu zhotoviteľovi, že uplatňuje zodpovednosť za vady, pričom je povinný písomne uviesť: popis väd diela, rozsah väd diela, čas zistenia väd diela.
- 4. Objednávateľ nadobudne vlastnícke právo k zhotovenému dielu až úplným zaplatením dohodnutej ceny podľa článku V. tejto zmluvy.

#### **X. Ukončenie zmluvy**

- 1. Zmluvné strany sa dohodli, že túto zmluvu je možné ukončiť:
  - a. vzájomnou písomnou dohodou zmluvných strán ku dňu uvedeného v písomnej dohode;

- b. odstúpením od zmluvy dodávateľom alebo objednávateľom v prípade podstatného porušenia niektorého z ustanovení tejto zmluvy. Za podstatné porušenie zmluvnej povinnosti sa bude považovať nedodržanie záväzku poskytnutia predmetu plnenia v dohodnutom množstve, kvalite a čase dodávateľom. Účinky odstúpenia nastávajú dňom doručenia písomného vyhotovenia tohto jednostranného písomného právneho úkonu druhému účastníkovi.

#### XI. Záverečné ustanovenie

1. Akékoľvek zmeny alebo doplnky k tejto zmluve sú pre zmluvné strany záväzné iba vtedy, ak sú vyhotovené v písomnej podobe ako dodatok zmluvy a obojstranne podpísané. Právne vzťahy neupravené touto zmluvou sa riadia príslušnými ustanoveniami Obchodného zákonníka.
2. Zmluvné strany sa zaväzujú, že si pri plnení záväzkov vzniknutých z tejto zmluvy vzájomne poskytnú nevyhnutnú súčinnosť.
3. Táto zmluva nadobúda platnosť dňom jej podpisu zmluvnými stranami a jej zverejnením v zmysle platných právnych predpisov. Zmluva so zhotoviteľom nadobúda účinnosť po splnení odkladacej podmienky, ktorá spočíva v tom, že dôjde k schváleniu procesu verejného obstarávania v plnom rozsahu, o čom bude dodávateľ informovaný.
4. Zmluvné strany vyhlasujú, že si túto zmluvu prečítali, jej obsahu porozumeli a na znak toho, že obsah tejto zmluvy zodpovedá ich skutočnej a slobodnej vôli, ju podpísali.
5. Zhotoviteľ je povinný strpieť výkon kontroly (audit) súvisiaceho s dodávaným tovarom, uskutočnenými stavebnými prácami a poskytnutými službami kedykoľvek počas platnosti a účinnosti Zmluvy, a to oprávnenými osobami a poskytnúť im všetku potrebnú súčinnosť.

Oprávnené osoby na výkon kontroly (audit) sú najmä:

- a. poskytovateľ a ním poverené osoby,
  - b. Útvar následnej finančnej kontroly a nimi poverené osoby,
  - c. Najvyšší kontrolný úrad SR, príslušná Správa finančnej kontroly, Certifikačný orgán a ním poverené osoby,
  - d. orgán auditu, jeho spolupracujúce orgány a nimi poverené osoby,
  - e. splnomocnení zástupcovia Európskej komisie a Európskeho dvora audítorov,
  - f. osoby prizvané orgánmi uvedenými v písm. a. až d. v súlade s príslušnými právnymi predpismi Slovenskej republiky a Európskej únie.
6. Nasledujúce prílohy tvoria neoddeliteľnú súčasť zmluvy.
    1. Test splnenia technických parametrov (TSTP) v rámci "Wifi pre Teba" rozšírený o konkrétne časti technických listov zodpovedajúcich relevantnému parametru,
    2. Podrobný popis prístupového bodu (AP) s väzbou na finančné limity,
    3. Technické listy dodávaných aktívnych prvkov.

V obci ..... Trebastovo ..... dňa ..... 19.4.2022 .....

Objednávateľ

Zhotoviteľ

.....  
Ivan Trjmaj  
Starosta obce Trebostovo

.....  
Mgr. Peter Moric, konateľ

**OBEC TREBOSTOVO**  
Hlavná 113/2, 038 41 Trebostovo  
IČO: 00316954, DIČ: 2020595038  
Tel.: 043/4294626, Fax: 043/4300590  
-2-

.....  
Ing. Richard Galčík, konateľ

**Príloha č. 1: Podrobný popis prístupového bodu (AP) s väzbou na finančné limity** (Uvedená príloha sa pri ŽoP predkladá iba v prípade, ak dodávateľ riešenia vystaví faktúru vo väčšom položkovom detaile ako je uvedené v prílohe č. 3 zmluvy o poskytnutí NFP (Rozpočet projektu), ktorý obsahuje len samostatné položky:

a. „Externý prístupový bod“ (počet)

b. „Interný prístupový bod“ (počet).

Položka	Merná jednotka	Počet jednotiek	Jednotková cena (v EUR s DPH)	Vysúťážená suma celkom (v EUR s DPH)	Limity podľa Príručky pre oprávnenosť výdavkov PO7 OPII pre dopytovo orientované projekty „Wifi pre Teba“ (max. suma za 1 AP v EUR s DPH)
Externý prístupový bod (AP) č. 1 - x:					1,500.00
					(nevyplní sa)
Externý prístupový bod	ks	4	960.00	4608.00	(nevyplní sa)
Inštalácia a konfigurácia AP	ks	4	190.00	912.00	(nevyplní sa)
SW manažment AP	ks	4	100.00	480.00	(nevyplní sa)
Spolu bez DPH					(nevyplní sa)
Celkom				6,000.00	

# Test splnenia technických parametrov (TSTP) v rámci "Wifi pre Teba"

TSTP slúži pre žiadateľa ako podklad pre špecifikáciu riešenia spĺňajúcu minimálne technické parametre požadovaných výzvou.

Technické parametre riešenia sú navrhnuté v súlade so schválenou Štúdiou uskutočiteľnosti <https://metais.finance.gov.sk/studia/detail/8c95df2d-700e-47ce-a1b0-4cbf3334b453?tab=documents> a musia spĺňať požiadavky Robustného, Spoľahlivého a Bezpečného produktu, ktorý poskytne občanom bezplatný prístup na internet prostredníctvom Wifi pripojenia.

- Robustný:** definuje minimálne technické parametre Prístupového bodu (Access pointu), resp. ostatného HW vybavenia,
- Spoľahlivý:** definuje minimálne podmienky pre poskytnutie kvalitného internetového pripojenia,
- Bezpečný:** definuje minimálne podmienky pre sieťovú a fyzickú bezpečnosť.

**Upozomenie:** výsledky tohto testu slúžia výlučne pre potreby žiadateľa a nie sú zárukou výsledku v procese schvaľovania žiadosti o NFP.

Otázka č.	Znenie otázky	Odkaz na relevantnú časť Technických listov (žiadateľ uvedie predmetnú časť technických listov, resp. iného relevantného zdroja zodpovedajúceho konkrétnemu parametru)	Odpoveď (po kliknutí na bunku vyberte jednu z možností)
1.	Kompaktné dvojpásmové WiFi zariadenia (2,4GHz - 5 GHz), ktoré sú certifikované pre európsky trh?	<a href="http://dl.ui.com/datasheets/unifi/UniFi_AC_Mesh_DS.pdf_str_4">http://dl.ui.com/datasheets/unifi/UniFi_AC_Mesh_DS.pdf_str_4</a>	Áno
2.	Životný cyklus použitých produktov vyšší ako 5 rokov?	Garantuje dodávateľ technológie GAYA, s. r. o.	Áno
3.	Stredná doba medzi poruchami (MTBF) minimálne 5 rokov?	Garantuje dodávateľ technológie GAYA, s. r. o.	Áno
4.	Možnosť centrálného manažmentu pre riadenie, monitoring a konfiguráciu siete (single point of management)?	<a href="http://dl.ui.com/datasheets/unifi/UniFi_AC_Mesh_DS.pdf_str_3">http://dl.ui.com/datasheets/unifi/UniFi_AC_Mesh_DS.pdf_str_3</a>	Áno
5.	Súlad s „802.11ac Wave 1, Institute of Electrical and Electronics Engineers“ (IEEE) štandardom?	<a href="http://dl.ui.com/datasheets/unifi/UniFi_AC_Mesh_DS.pdf_str_8">http://dl.ui.com/datasheets/unifi/UniFi_AC_Mesh_DS.pdf_str_8</a>	Áno
6.	Podpora 802.1x IEEE štandardu?	<a href="https://dl.ubnt.com/guides/UniFi/UniFi_Controller_V5_UG.pdf_str_47">https://dl.ubnt.com/guides/UniFi/UniFi_Controller_V5_UG.pdf_str_47</a>	Áno
7.	Podpora 802.11r IEEE štandardu?	<a href="http://dl.ui.com/datasheets/unifi/UniFi_AC_Mesh_DS.pdf_str_8">http://dl.ui.com/datasheets/unifi/UniFi_AC_Mesh_DS.pdf_str_8</a>	Áno
8.	Podpora 802.11k IEEE štandardu?	<a href="http://dl.ui.com/datasheets/unifi/UniFi_AC_Mesh_DS.pdf_str_8">http://dl.ui.com/datasheets/unifi/UniFi_AC_Mesh_DS.pdf_str_8</a>	Áno
9.	Podpora 802.11v IEEE štandardu?	<a href="http://dl.ui.com/datasheets/unifi/UniFi_AC_Mesh_DS.pdf_str_8">http://dl.ui.com/datasheets/unifi/UniFi_AC_Mesh_DS.pdf_str_8</a>	Áno
10.	Schopnosť AP obsluhovať naraz aspoň 50 rôznych užívateľov bez zníženia kvality služby?	<a href="http://dl.ui.com/datasheets/unifi/UniFi_AC_Mesh_DS.pdf_str_8">http://dl.ui.com/datasheets/unifi/UniFi_AC_Mesh_DS.pdf_str_8</a>	Áno
11.	Minimálne 2x2 MIMO (multiple-input-multiple-output)?	<a href="http://dl.ui.com/datasheets/unifi/UniFi_AC_Mesh_DS.pdf_str_4">http://dl.ui.com/datasheets/unifi/UniFi_AC_Mesh_DS.pdf_str_4</a>	Áno
12.	Súlad s Hotspot 2.0 (Passpoint WiFi Alliance certification program)?	Výrobca v procese certifikácie, technický súlad garantujeme	Áno
13.	Súčasťou dodávky bude: projektová dokumentácia ktorá bude obsahovať sieťové zapojenie aktívnych prvkov siete s IP adresným plánom, Simuláciu pokrytia priestoru, Meranie skutočného pokrytia, technické listy aktívnych prvkov, funkčný popis a vyobrazenie obsahu hotspot portálu s umiestneným logom	Súčasťou zmluvy o dodaní tovaru "Dodanie bezdrôtových prístupových bodov na verejných priestranstvách v rámci obce Košťany nad Turcom." v znení neskoršom dodatku č.1 v časti II.PREDMET DODATKU Bod Ad. III.	Áno

Všetky otázky sú zodpovedané

Minimálne technické podmienky sú zadané.

Počet odpovedí "nie"
Počet nezodpovedaných otázok



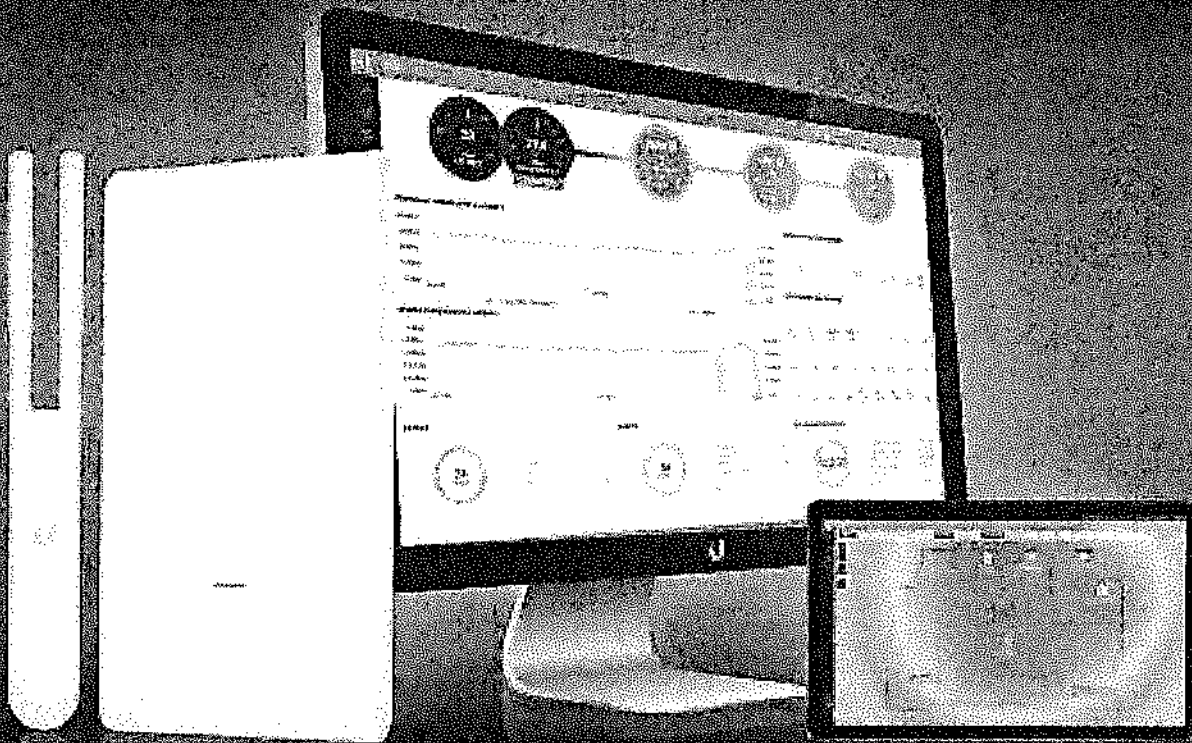

## UniFi<sup>®</sup> AC MESH

802.11AC AP with Plug & Play Mesh

Models: UAP-AC-M, UAP-AC-M-PRO

High-Performance Wide-Area Wi-Fi with UniFi<sup>®</sup> Mesh Technology.

Breakthrough Speeds up to 1300 Mbps in the 5 GHz Band

802.3af PoE Compatibility



## Scalable Enterprise Wi-Fi Management

UniFi is the revolutionary Wi-Fi system that combines enterprise performance, unlimited scalability, and a central management controller. The UniFi AC Mesh APs have a refined industrial design and can be easily installed using the included mounting hardware.

Easily accessible through any standard web browser, the UniFi Controller software is a powerful software engine ideal for high-density client deployments requiring low latency and high uptime performance.

Use the UniFi Controller software to quickly configure and administer an enterprise Wi-Fi network – no special training required. RF map and performance features, real-time status, automatic UAP device detection, and advanced security options are all seamlessly integrated.

## Features

**Save money and save time** UniFi comes bundled with a non-dedicated software controller that can be deployed on an on-site PC, Mac, or Linux machine; in a private cloud; or using a public cloud service. You also have the option of using the UniFi Cloud Key with built-in software.

**Powerful Hardware** The UniFi AC Mesh APs feature Wi-Fi 802.11AC with Plug & Play Mesh technology.

**Intuitive UniFi Controller Software** Configure and manage your APs with the easy-to-learn user interface.

**Expandable** Unlimited scalability; build wireless networks as big or small as needed. Start with one and expand to thousands while maintaining a single unified management system.

## Extend Your Coverage

With the UniFi Controller software running in a NOC or in the cloud, administrators can manage multiple sites; multiple distributed deployments and multi-tenancy for managed service providers. Below are some deployment examples.

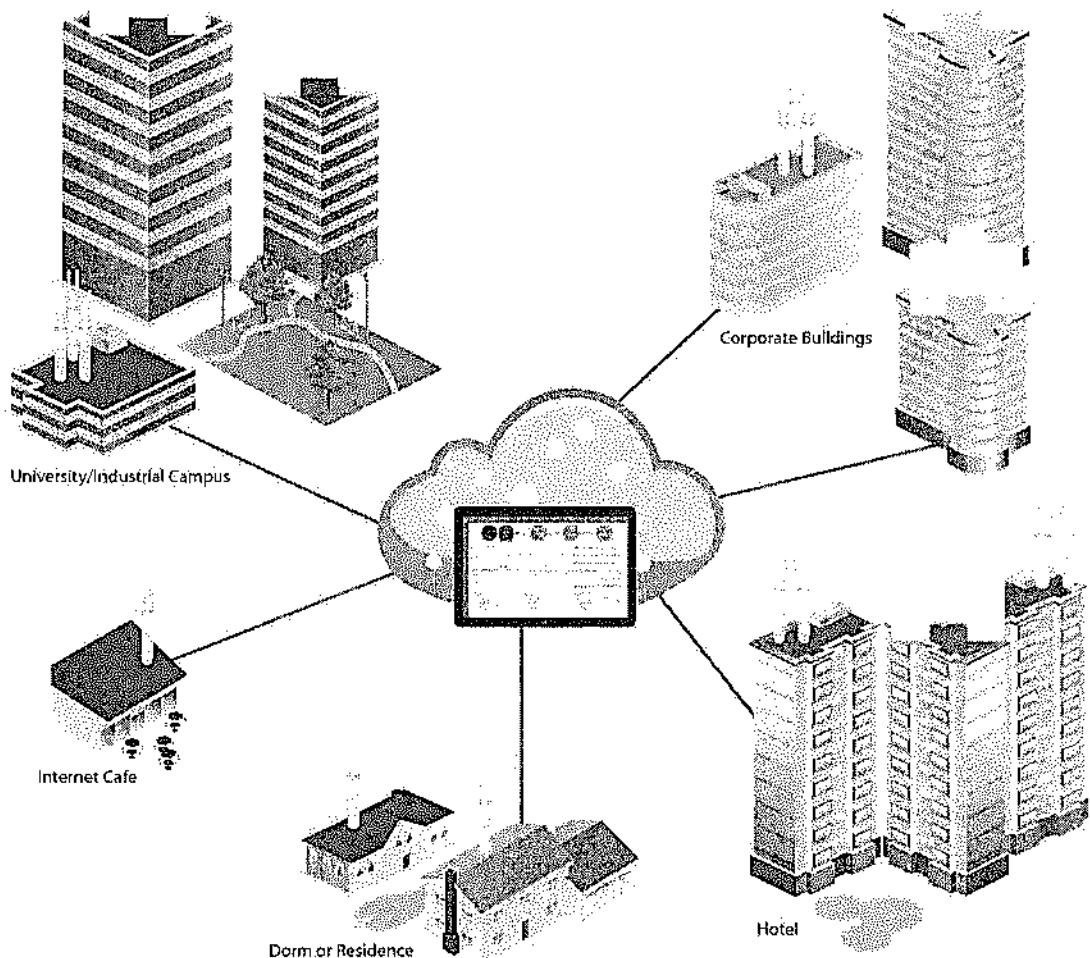

# UniFi Controller

## Packed with Features

Use the UniFi Controller to provision thousands of UniFi APs, map out networks, quickly manage system traffic, and provision additional UniFi APs.

## Breakthrough RF Map

Use the RF map to monitor and analyze radio frequencies for optimal AP placement, configuration, and troubleshooting.

## Powerful RF Performance Features

Advanced RF performance and configuration features include spectral analysis, airtime fairness, and band steering.

## Detailed Analytics

Use the configurable reporting and analytics to manage large user populations and expedite troubleshooting.

## Wireless Uplink

Wireless Uplink functionality enables wireless connectivity between APs for extended range. One wired UniFi AP uplink supports up to four wireless downlinks on a single operating band, allowing wireless adoption of devices in their default state and real-time changes to network topology.

For devices that support Plug & Play Mesh, this functionality is extended to allow multi-hop wireless uplink – so wirelessly uplinked APs can support uplink to other wirelessly uplinked APs.

## Guest Portal/Hotspot Support

Easy customization options for Guest Portals include authentication, Hotspot setup, and the ability to use your own external portal server. Use UniFi's rate limiting for your Guest Portal/Hotspot package offerings. Apply different bandwidth rates (download/upload), limit total data usage, and limit duration of use.

All UniFi APs include Hotspot functionality:

- Built-in support for billing integration using major credit cards.
- Built-in support for voucher-based authentication.
- Built-in Hotspot Manager for voucher creation, guest management, and payment refund.
- Full customization and branding of Hotspot portal pages.

## Multi-Site Management

A single cloud-based UniFi Controller can manage multiple sites: multiple, distributed deployments and multi-tenancy for managed service providers. Each site is logically separated and has its own configuration, maps, statistics, guest portal, and admin read/write and read-only accounts.

## WLAN Groups

Manage flexible configurations of large deployments. Create multiple WLAN groups and assign them to an AP's radio.

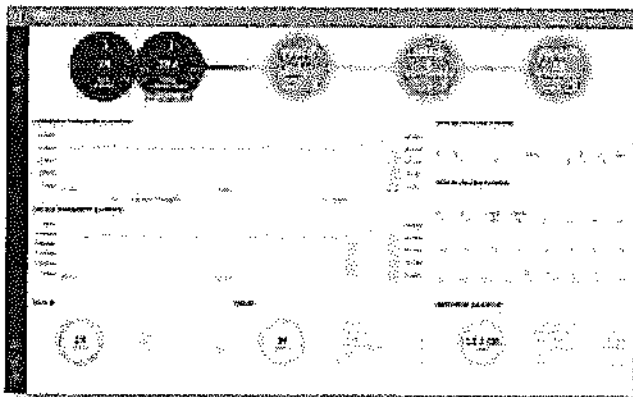

## Dashboard

UniFi provides a visual representation of your network's status and delivers basic information about each network segment.

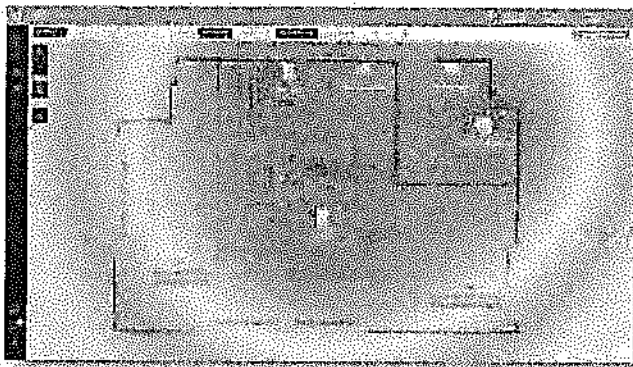

## RF Map

Monitor UniFi APs and analyze the surrounding RF environment.

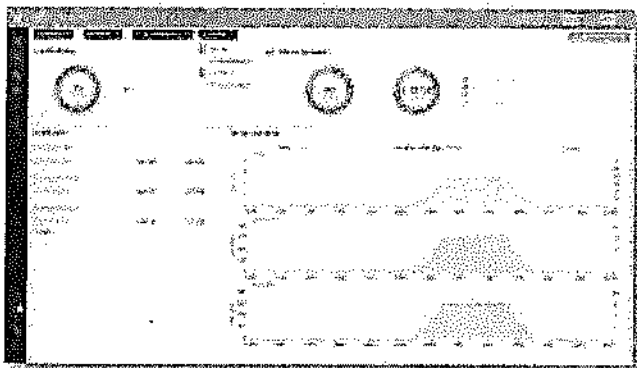

## Statistics

UniFi organizes and visualizes network traffic in clear and easy-to-read graphs.

## Model Comparison

	UAP-AC-M	UAP-AC-M-PRO
Environment	Indoor/Outdoor	Indoor/Outdoor
Simultaneous Dual-Band	Yes	Yes
2.4 GHz Speed*	450 Mbps	450 Mbps
2.4 GHz MIMO	2x2	3x3
5 GHz Speed*	450 Mbps	450 Mbps
5 GHz MIMO	2x2	3x3
Range*	100 ft (30 m)	100 ft (30 m)
Secondary Ethernet Port	Yes	Yes
PoE Mode	IEEE 802.3af IEEE 802.3at	IEEE 802.3af
Wall Mount	Yes	Yes
Pole Mount	Yes	Yes
Fast Mount	Yes	Yes

\* Speed and Range values may vary and are based on optimal environments.

## Use Cases

**Mesh Multi-Hop** A large outdoor area, such as a park with minimal infrastructure, can take advantage of a mesh network comprised of the UniFi AC Mesh models.

**Omnidirectional Coverage, Indoors/Outdoors** The UniFi AC Mesh AP includes adjustable dual-band omni antennas, and you have the option to use any 5 GHz omni antenna for spot-beam coverage in high-density locations with numerous APs and clients, like a conference hall.

**Directional Coverage, Outdoors** The UniFi AC Mesh AP is versatile; you can use any 5 GHz sector antenna (wide beam in the azimuth plane and narrow in the elevation plane) for broad outdoor coverage.

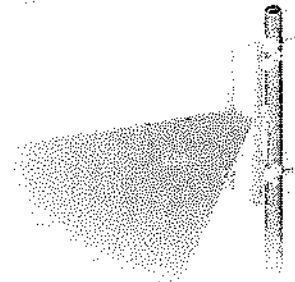

airMAX® ac Sector, model AM-SAC21-60

**Maximum Coverage, Outdoors** The UniFi AC Mesh Pro AP is ideal for applications requiring 3x3 MIMO data rates for close-in omni coverage.

**Temporary Installations** Deploy the UniFi AC Mesh models for outdoor installations requiring quick setup and takedown, such as a music festival or concert venue.

## Application Example

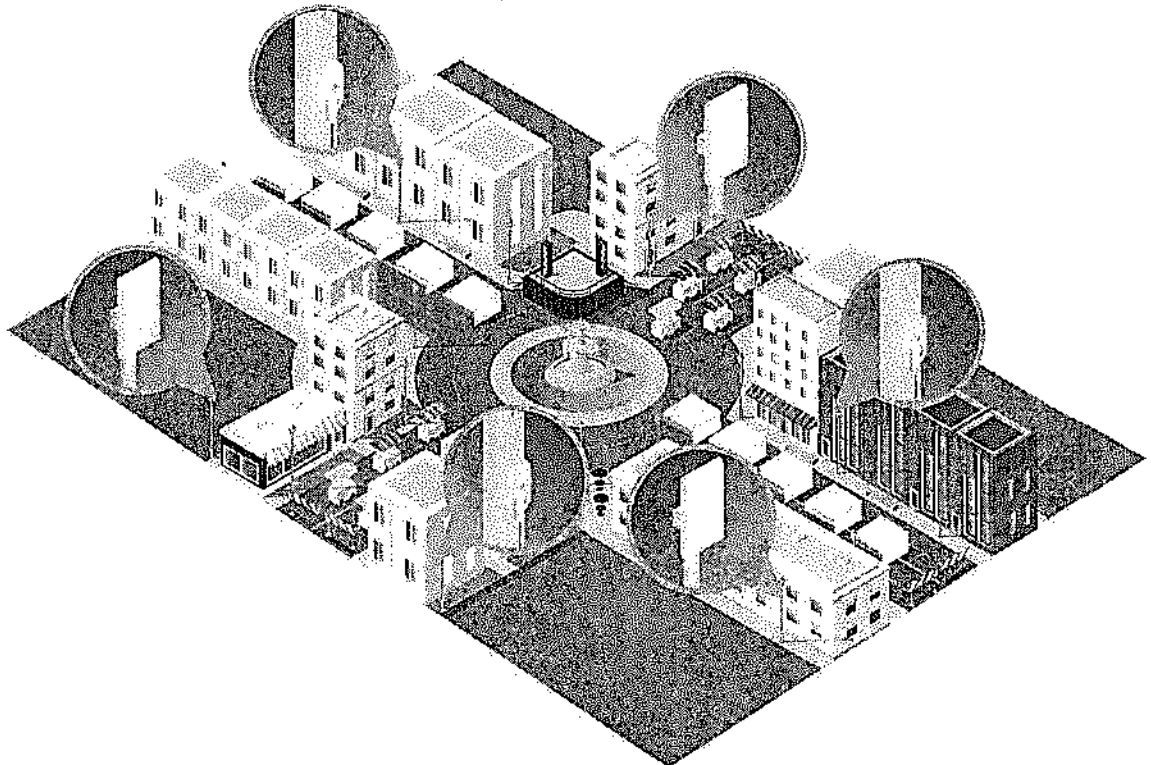

Both UniFi AC Mesh models provide wireless coverage for a street fair in a city plaza.

# Hardware Overview

## Model: UAP-AC-M

**Compact Form Factor** The UniFi AC Mesh AP is designed to discreetly integrate into any environment.

**Weather-Resistant Enclosure** The UniFi AC Mesh AP can be used indoors or outdoors.

**LED** Unique provisioning LED provides administrator location tracking and alerts for each device.

**Versatile Mounting** The UniFi AC Mesh AP can be mounted on a wall, pole, or fast-mount of a Ubiquiti high-gain antenna. (All accessories are included.)

**Multiple Power Options** The UniFi AC Mesh AP is compatible with 802.3af PoE Alternative A and 24V passive PoE. You can power it with an 802.3af Alternative A compatible switch, EdgePoint™ EP-R6, UniFi PoE Switch, or the included Gigabit PoE adapter.

**Antenna Options** Use the included omni antennas, or use the included fast-mount adapter to install the AP on an optional connectorized antenna for expanded range coverage and customized pattern shaping.

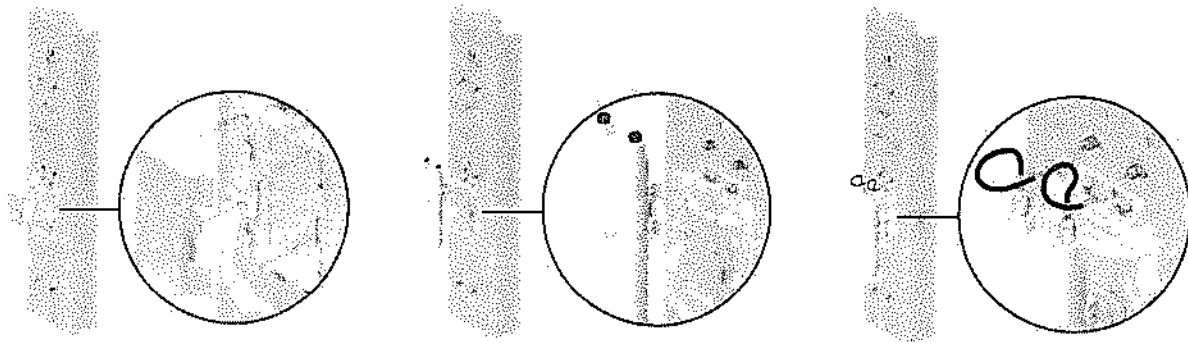

The included fast-mount adapter attaches to the radio mount of an optional airMAX antenna.

## Application Example

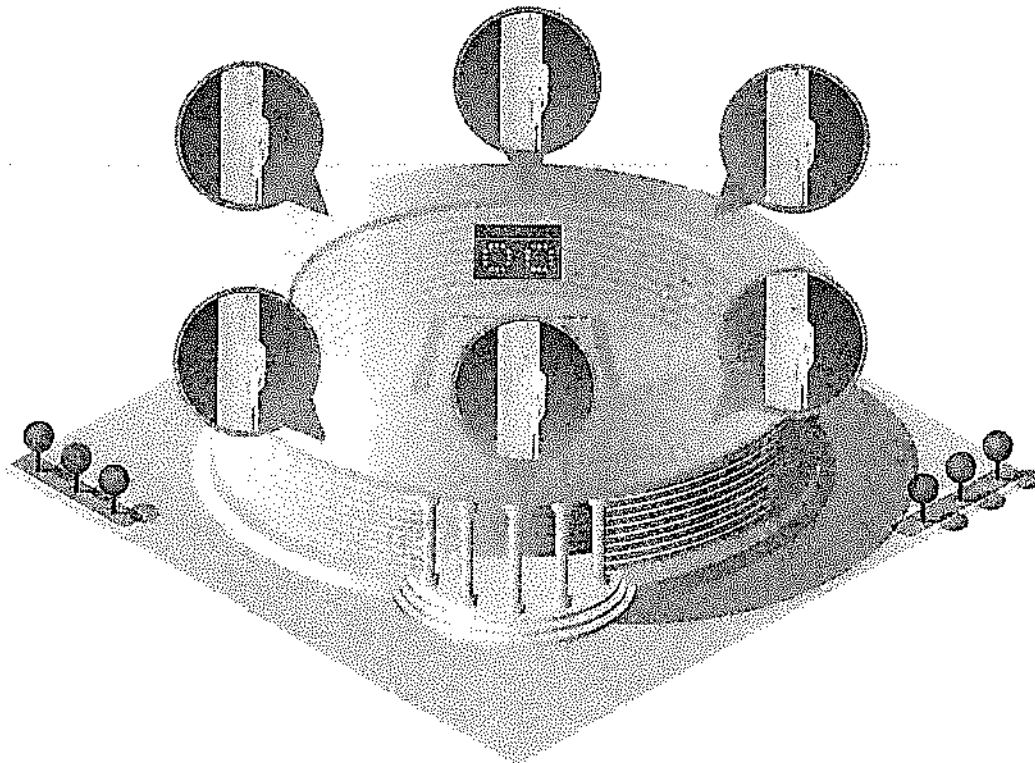

Pair the UniFi AC Mesh APs with airMAX 5 GHz sector antennas for directional coverage of an indoor stadium.

## Hardware Overview

### Model: UAP-AC-M-PRO

**Weather-Resistant Form Factor** The enclosure of the UniFi AC Mesh Pro AP is designed to withstand the elements, making it ideal for outdoor deployment.

**LED** Unique provisioning LED provides administrator location tracking and alerts for each device.

**Powerful Coverage** Built-in dual-band omnidirectional antennas deliver expanded range coverage outdoors.

**Mounting Flexibility** The UniFi AC Mesh Pro AP can be mounted on a wall or pole. (All accessories are included.)

**Dual Gigabit Ethernet Ports** The primary port is for data and PoE; the secondary port is for bridging.

**Multiple Power Options** You can power the UniFi AC Mesh Pro AP with an 802.3af compatible switch, UniFi PoE Switch, or the included Gigabit PoE adapter. We recommend powering your UniFi devices with a UniFi PoE Switch (sold separately).

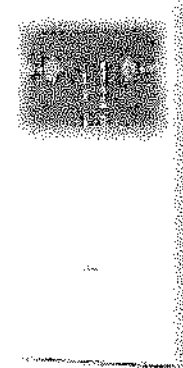

### Application Example

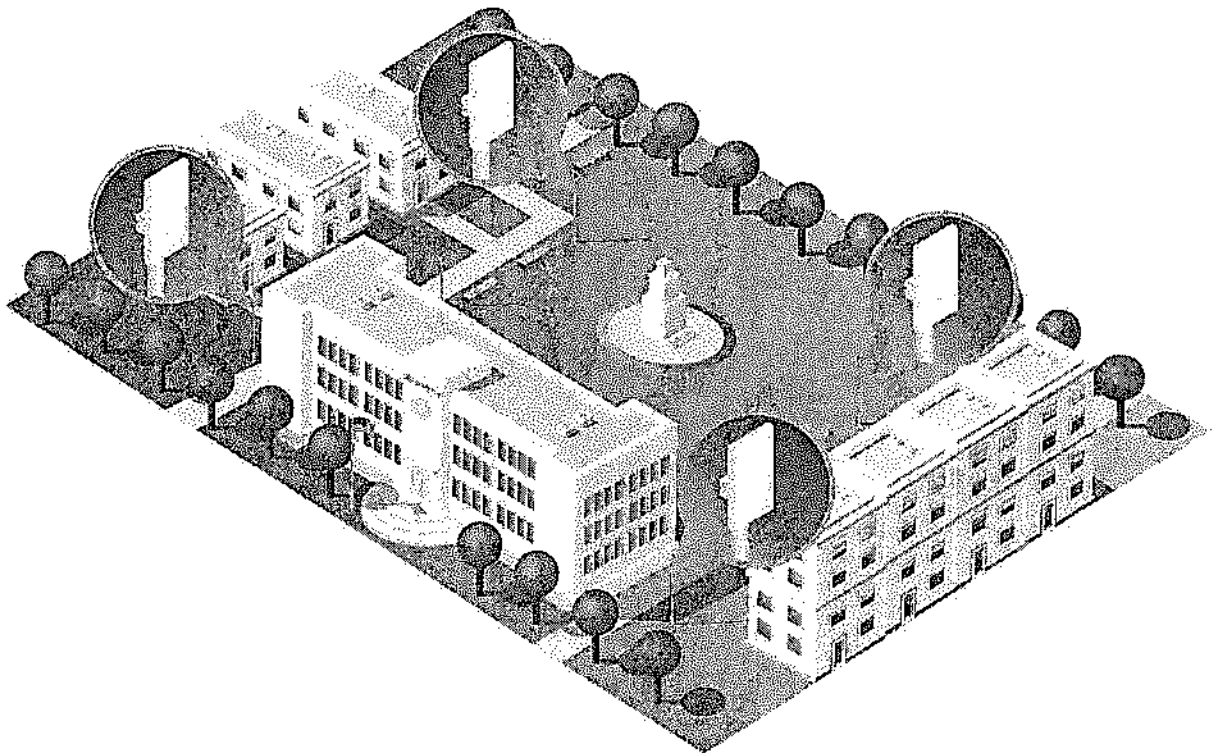

*The UniFi AC M Pro APs cover the quad and park on a university campus.*

# UAP-AC-M Specifications

UAP-AC-M	
Dimensions	353 x 46 x 34.4 mm (13.9 x 1.81 x 1.35")
Weight	152 g (5.36 oz) with Antennas
Networking Interface	(1) 10/100/1000 Ethernet Port
Buttons	Reset
Power Method	24V Passive PoE (Pairs 4, 5+; 7, 8 Return); 802.3af Alternative A (Pairs 1, 2+; 3, 6 Return) (Supported Voltage Range: 44 to 57VDC)
Power Supply	24V, 0.5A Gigabit PoE Adapter (Included)
Power Save	Supported
Maximum Power Consumption	8.5W
Maximum TX Power	
2.4 GHz	20 dBm
5 GHz	20 dBm
Antennas	(2) External Dual-Band Omni Antennas
2.4 GHz	3 dBi
5 GHz	4 dBi
Wi-Fi Standards	802.11 a/b/g/n/ac
Wireless Security	WEP, WPA-PSK, WPA-Enterprise (WPA/WPA2, TKIP/AES)
BSSID	Up to Four per Radio
Mounting	Wall/Pole/Fast-Mount (Kits Included)
Operating Temperature	-30 to 70° C (-22 to 158° F)
Operating Humidity	5 to 95% Noncondensing
Certifications	CE, FCC, IC

Advanced Traffic Management	
VLAN	802.1Q
Advanced QoS	Per-User Rate Limiting
Guest Traffic Isolation	Supported
WMM	Voice, Video, Best Effort, and Background
Concurrent Clients	200+

Supported Data Rates (Mbps)	
Standard	Data Rates
802.11ac	6.5 Mbps to 867 Mbps (MCS0 - MCS9 NSS1/2, VHT 20/40/80)
802.11n	6.5 Mbps to 300 Mbps (MCS0 - MCS15, HT 20/40)
802.11a	6, 9, 12, 18, 24, 36, 48, 54 Mbps
802.11g	6, 9, 12, 18, 24, 36, 48, 54 Mbps
802.11b	1, 2, 5.5, 11 Mbps

# UAP-AC-M-PRO Specifications

UAP-AC-M-PRO	
Dimensions	343.2 x 181.2 x 60.2 mm (13.51 x 7.13 x 2.37")
Weight	633 g (1.40 lb)
Networking Interface	(2) 10/100/1000 Ethernet Ports
Buttons	Reset
Power Method	802.3af PoE (Supported Voltage Range: 44 to 57VDC)
Power Supply	48V, 0.5A PoE Gigabit Adapter (Included)
Power Save	Supported
Maximum Power Consumption	9W
Maximum TX Power	
2.4 GHz	22 dBm
5 GHz	22 dBm
Antennas	(3) Internal Dual-Band Antennas 8 dBi
Wi-Fi Standards	802.11 a/b/g/n/ac
Wireless Security	WEP, WPA-PSK, WPA-Enterprise (WPA/WPA2, TKIP/AES)
BSSID	Up to Four per Radio
Mounting	Wall/Pole (Pole Kit Included)
Operating Temperature	-40 to 70° C (-40 to 158° F)
Operating Humidity	5 to 95% Noncondensing
Certifications	CE, FCC, IC

Advanced Traffic Management	
VLAN	802.1Q
Advanced QoS	Per-User Rate Limiting
Guest Traffic Isolation	Supported
WMM	Voice, Video, Best Effort, and Background
Concurrent Clients	200+

Supported Data Rates (Mbps)	
Standard	Data Rates
802.11ac	6.5 Mbps to 1300 Mbps (MCS0 - MCS9-NSS1/2/3, VHT 20/40/80)
802.11n	6.5 Mbps to 450 Mbps (MCS0 - MCS23, HT 20/40)
802.11a	6, 9, 12, 18, 24, 36, 48, 54 Mbps
802.11g	6, 9, 12, 18, 24, 36, 48, 54 Mbps
802.11b	1, 2, 5.5, 11 Mbps

Specifications are subject to change. Ubiquiti products are sold with a limited warranty described at [www.ubnt.com/support/warranty](http://www.ubnt.com/support/warranty)  
 ©2015-2016 Ubiquiti Networks, Inc. All rights reserved. Ubiquiti, Ubiquiti Networks, the Ubiquiti U logo, the Ubiquiti beam logo, airMAX, airOS, EdgePoint, and UniFi are trademarks or registered trademarks of Ubiquiti Networks, Inc. in the United States and in other countries. All other trademarks are the property of their respective owners.



[www.ubnt.com](http://www.ubnt.com)



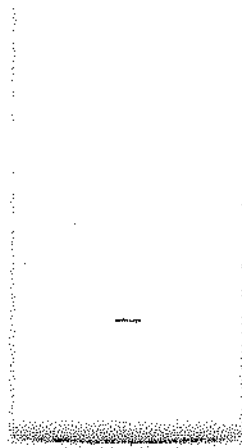

**Unifi** **AC MESH PRO**

802.11AC 3x3 MIMO Outdoor  
AP with Plug & Play Mesh

Model: UAP-AC-M-PRO

QUICK START GUIDE

## Introduction

Thank you for purchasing the Ubiquiti Networks® UniFi® 802.11AC 3x3 MIMO Outdoor Access Point with Plug & Play Mesh Technology. This Quick Start Guide is designed to guide you through installation and includes warranty terms.

 **Important:** The UAP-AC-M-PRO requires the UniFi Controller v5.1.1 or newer, available at: [downloads.ubnt.com/uniifi](http://downloads.ubnt.com/uniifi)

## Package Contents

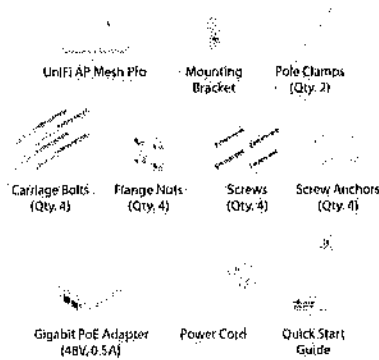

**DISCLAIMER:** Ubiquiti radio devices must be professionally installed. Shielded Ethernet cable and earth grounding must be used as conditions of product warranty. "Shield Cable" is designed for outdoor installation. It is the customer's responsibility to follow local authority regulations, including operation within legal frequency channels, output power, and Dynamic Frequency Selection (DFS) requirements.

### Installation Requirements

- 13 mm wrench (for pole mounting)
- Cable feed must be pointed downwards when mounted.
- Shielded Category 5 (or above) cabling should be used for all outdoor wired Ethernet connections and should be grounded through the AC ground of the PoE.

We recommend that you protect your networks from harmful outdoor environments and destructive ESD events with industrial-grade, shielded Ethernet cable from Ubiquiti Networks. For more details, visit: [www.ubnt.com/toughcable](http://www.ubnt.com/toughcable)

### System Requirements

- Linux, Mac OS X, or Microsoft Windows 7/8/10
- Java Runtime Environment 1.6 (1.8 or newer recommended)
- Web Browser: Google Chrome (Other browsers may have limited functionality)
- UniFi Controller software v5.1.1 or newer, available at: [downloads.ubnt.com/unifi](http://downloads.ubnt.com/unifi)

### Wireless Adoption Requirements

The UAP-AC-M-PRO supports wireless adoption into your UniFi Wi-Fi network. This feature requires a currently managed UniFi AP operating with the following configuration:

- The UniFi AP must be running firmware 3.7.7 or newer
- At least one SSID enabled and operating on 5 GHz band
- The UAP-AC-M-PRO must be within wireless range of the UniFi AP



## Hardware Overview

### LED

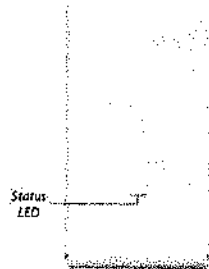

LED Color	Status
Flashing White	Initializing.
Steady White	Factory default, waiting to be integrated.
Alternating White/Blue	Device is busy; do not touch or unplug it. This usually indicates that a process such as a firmware upgrade is taking place.
Quickly Flashing Blue	Used to locate and identify a UniFi device. When the Locate feature is activated in the UniFi Controller software, the Status LED will flash blue. It will also display the location of the device on the map.
Steady Blue	Indicates the device has been successfully integrated into a network and is working properly.
Steady Blue with occasional flashing	Indicates the device is in an isolated state (all WLANs are brought down until an uplink is found).

## Ports

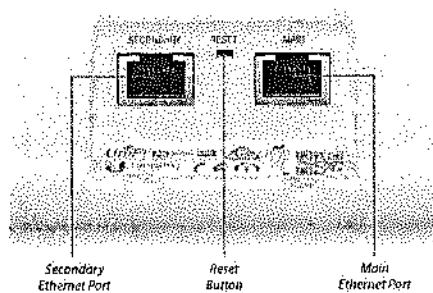

**Secondary** The *Secondary* port is a Gigabit Ethernet port used for bridging.

**Reset** The *Reset* button serves two functions for the UniFi AP:

- **Restart** Press and release the *Reset* button quickly.
- **Restore to Factory Default Settings** Press and hold the *Reset* button for more than five seconds.

**Main** The *Main* port is a Gigabit PoE port used to connect the power and should be connected to the LAN and DHCP server. Power can be provided by one of the following:

- *Gigabit PoE Adapter* (included)
- Ubiquiti Networks UniFi Switch with PoE
- 802.3af/802.3at PoE+ compliant switch

## Hardware Installation

The UAP-AC-M-PRO includes hardware for mounting on a pole or mast. Alternatively, it can be installed on a wall using additional fastening hardware.

### Pole Mount

1. Insert two *Carriage Bolts* into each *Pole Clamp* and attach a *Flange Nut* on each bolt.



 **Note:** The mounting assembly can accommodate a  $\varnothing 38 - 76$  mm pole.

2. Remove the *Mounting Bracket* from the back of the UniFIAP by depressing the two snap pins.

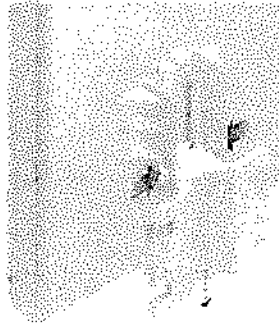

3. Attach one of the *Pole Clamps* to the pole by sliding the *Carriage Bolts* around the pole and into the top two slots of the *Mounting Bracket*.

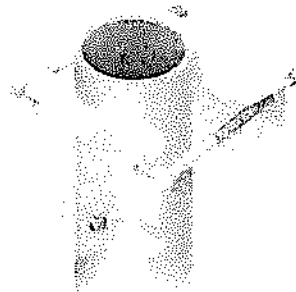

4. Uniformly hand-tighten each *Flange Nut*. Ensure the *Pole Clamp* is evenly clamped around the pole and tighten each *Flange Nut* to approximately 25 N·m.
5. Repeat steps 2 and 3 for the second *Pole Clamp*.





6. Attach the UniFi AP to the *Mounting Bracket*:
  - a. Position the UniFi AP with the *Mounting Bracket* aligned between the mounting tabs on the back of the UniFi AP.
  - b. Slide the UniFi AP downward into the grooves of the *Mounting Bracket* until the snap pins engage and lock the UniFi AP in place.

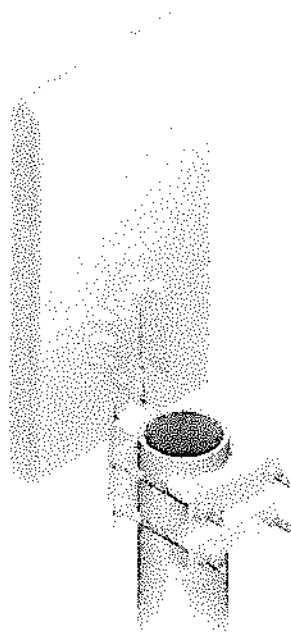

### Wall Mount

To mount the UniFi AP on a wall, securely attach the *Mounting Bracket* to the wall using four fasteners (not included).

 Note: The *Mounting Bracket* must attach directly to a stud or other structurally stable surface.

1. Locate the stud.
2. Position the *Mounting Bracket* on the stud, ensuring at least two holes are centered on the stud.
3. Mark and drill the four holes.
4. Insert the *Screw Anchors* in the holes as necessary.
5. Secure the *Mounting Bracket* to the wall the four *Screws*.

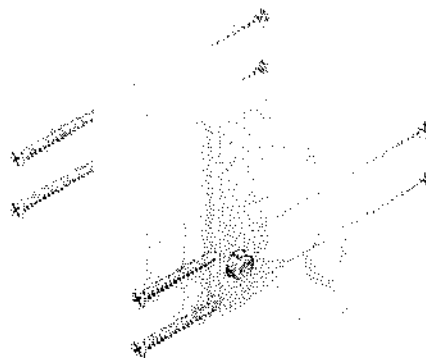

6. Attach the UniFi AP to the *Mounting Bracket*:
  - a. Position the UniFi AP with the *Mounting Bracket* aligned between the mounting tabs on the back of the UniFi AP.
  - b. Slide the UniFi AP downward into the grooves of the *Mounting Bracket* until the snap pins engage and lock the UniFi AP in place.



### Connecting Ethernet

1. Press down on the center of the port cover and slide it downward to remove it.

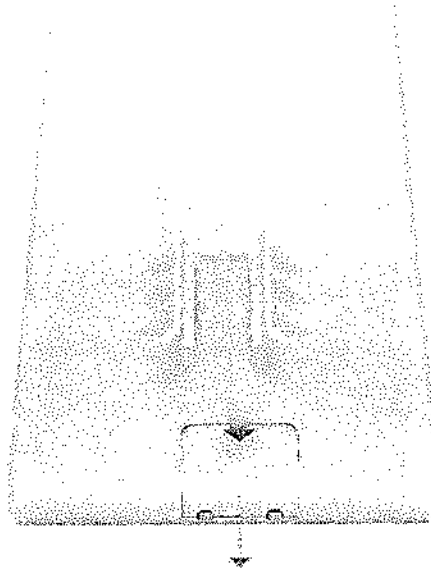

2. Connect an Ethernet cable to the *Main* port.

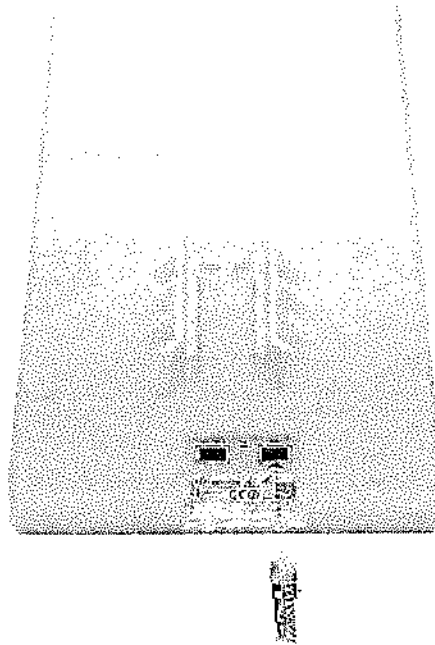

3. Replace the port cover.

## Powering the UniFi AP

Power the UniFi AP with the included *Power Adapter* or an 802.3af PoE switch.

### Powering with a PoE Adapter

1. Connect the Ethernet cable from the UniFi AP to the **POE** part of the *Gigabit PoE* adapter.
2. (Optional for non-mesh setup) Connect an Ethernet cable from your LAN to the **LAN** port of the *Gigabit PoE* adapter.
3. Connect the *Power Cord* to the adapter and then plug the *Power Cord* into a power outlet.



### Mounting the PoE Adapter (Optional)

1. Remove the *PoE Mounting Bracket* from the adapter, place the bracket at the desired location, and mark the two holes.
2. Pre-drill the holes if necessary, and secure the bracket using two fasteners (not included).
3. Align the slots on the adapter with the tabs of the *PoE Mounting Bracket*, and then slide the adapter down.



640-00241-05

### Powering with a PoE Switch

Connect the Ethernet cable from the UniFi AP directly to a PoE port on an 802.3af switch. PoE will automatically be enabled.

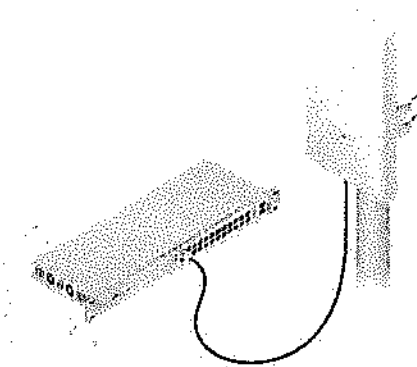

Connected to UniFi Switch, model US-24-250W

### Wireless Adoption

See the *Wireless Adoption Requirements* on page 3 before proceeding.

1. Ensure the UAP-AC-M-PRO is powered on, and then launch the UniFi Controller software.
2. Go to the *Devices* page, and the UAP-AC-M-PRO will show up as *Pending Approval (Wireless)*.
3. Click *Adopt*.

For information on configuring and using the UniFi Controller software, refer to the *User Guide* located on our website: [documentation.ubnt.com/unifi](http://documentation.ubnt.com/unifi)

## Software installation

If you are not running the UniFi Controller software version 5.1.1 or newer, download and install the latest version from: [downloads.ubnt.com/unifi](https://downloads.ubnt.com/unifi)

Launch the software and follow the on-screen instructions. Step-by-step instructions are available in the User Guide.

After you have installed the software and run the UniFi Installation Wizard, a login screen will appear for the UniFi Controller management interface. Enter the Username and Password that you created and click Login.



You can adopt devices, manage your wireless network, and view network statistics using the UniFi Controller management interface.

## Mobile App Installation

Ubiquiti Networks also offers the UniFi mobile app, which is available from the App Store (iOS) or Google Play™ Store (Android). You can use it to provision a UniFi AP for basic functionality without configuring a UniFi Controller. It also allows seamless provisioning of APs for remote controllers (controllers not on the same layer-2 network) and easy access to both local controllers and those monitored on [unifi.ubnt.com](https://unifi.ubnt.com).



## Specifications

Dimensions	343.2 x 181.2 x 60.2 mm (13.51 x 7.13 x 2.37")
Weight	633 g (1.40 lb)
Networking Interface	(2) 10/100/1000 Ethernet Ports
Buttons	Reset
Power Method	802.3af PoE
Power Supply	48V, 0.5A PoE Gigabit Adapter (Included)
Supported Voltage Range	44VDC to 57VDC
Max. Power Consumption	9W
Max. TX Power	
2.4 GHz	22 dBm
5 GHz	22 dBm
MIMO	
2.4 GHz	3 x 3
5 GHz	3 x 3
Throughput Speeds*	
2.4 GHz	450 Mbps
5 GHz	1300 Mbps
Range*	183 m (600 ft)
Antennas	(3) Dual-Band Internal
Antenna Gain	8 dBi
Wi-Fi Standards	802.11 a/b/g/n/ac
Wireless Security	WEP, WPA, PSK, WPA Enterprise (WPA2/PA2, TKIP/AES)
BSSID	Up to Four per Radio
Mounting	Wall/Pole (Pole Kit Included)
Operating Temperature	-40 to 70° C (-40 to 158° F)
Operating Humidity	5 - 95% Noncondensing
Certifications	CE, FCC, IC

\* Speed and range values may vary and are based on optimal environments.

### Safety Notices

1. Read, follow, and keep these instructions.
2. Heed all warnings.
3. Only use attachments/accessories specified by the manufacturer.



**WARNING:** Do not use this product in location that can be submerged by water.



**WARNING:** Avoid using this product during an electrical storm. There may be a remote risk of electric shock from lightning.

### Electrical Safety Information

1. Compliance is required with respect to voltage, frequency, and current requirements indicated on the manufacturer's label. Connection to a different power source than those specified may result in improper operation, damage to the equipment or pose a fire hazard if the limitations are not followed.
2. There are no operator serviceable parts inside this equipment. Service should be provided only by a qualified service technician.
3. This equipment is provided with a detachable power cord which has an integral safety ground wire intended for connection to a grounded safety outlet.
  - a. Do not substitute the power cord with one that is not the provided approved type. Never use an adapter plug to connect to a 2-wire outlet as this will defeat the continuity of the grounding wire.
  - b. The equipment requires the use of the ground wire as a part of the safety certification, modification or misuse can provide a shock hazard that can result in serious injury or death.
  - c. Contact a qualified electrician or the manufacturer if there are questions about the installation prior to connecting the equipment.
  - d. Protective earthing is provided by Listed AC adapter. Building installation shall provide appropriate short-circuit backup protection.
  - e. Protective bonding must be installed in accordance with local national wiring rules and regulations.

### Limited Warranty

UBIQUITI NETWORKS, Inc ("UBIQUITI NETWORKS") warrants that the product(s) furnished hereunder (the "Product(s)") shall be free from defects in material and workmanship for a period of one (1) year from the date of shipment by UBIQUITI NETWORKS under normal use and operation. UBIQUITI NETWORKS' sole and exclusive obligation and liability under the foregoing warranty shall be for UBIQUITI NETWORKS, at its discretion, to repair or replace any Product that fails to conform to the above warranty during the above warranty period. The expense of removal and reinstallation of any Product is not included in this warranty. The warranty period of any repaired or replaced Product shall not extend beyond its original term.

### Warranty Conditions

The above warranty does not apply if the Product:

- (I) has been modified and/or altered, or an addition made thereto, except by Ubiquiti Networks, or Ubiquiti Networks' authorized representatives, or as approved by Ubiquiti Networks in writing;
- (II) has been painted, rebranded or physically modified in any way;
- (III) has been damaged due to errors or defects in cabling;
- (IV) has been subjected to misuse, abuse, negligence, abnormal physical, electromagnetic or electrical stress, including lightning strikes, or accident;
- (V) has been damaged or impaired as a result of using third party firmware;
- (VI) has no original Ubiquiti MAC label, or is missing any other original Ubiquiti label(s); or
- (VII) has not been received by Ubiquiti within 30 days of issuance of the RMA.

In addition, the above warranty shall apply only if: the product has been properly installed and used at all times in accordance, and in all material respects, with the applicable Product documentation; all Ethernet cabling runs use CAT5 (or above), and for outdoor installations, shielded Ethernet cabling is used, and for indoor installations, indoor cabling requirements are followed.

### Returns

No Products will be accepted for replacement or repair without obtaining a Return Materials Authorization (RMA) number from UBIQUITI NETWORKS during the warranty period, and the Products being received at UBIQUITI NETWORKS' facility freight prepaid in accordance with the RMA process of UBIQUITI NETWORKS. Products returned without an RMA number will not be processed and will be returned freight collect or subject to disposal. Information on the RMA process and obtaining an RMA number can be found at: [www.ubnt.com/support/warranty](http://www.ubnt.com/support/warranty).

#### Disclaimer

EXCEPT FOR ANY EXPRESS WARRANTIES PROVIDED HEREIN, UBIQUITI NETWORKS, ITS AFFILIATES, AND ITS AND THEIR THIRD PARTY DATA, SERVICE, SOFTWARE AND HARDWARE PROVIDERS HEREBY DISCLAIM AND MAKE NO OTHER REPRESENTATION OR WARRANTY OF ANY KIND, EXPRESS, IMPLIED OR STATUTORY, INCLUDING, BUT NOT LIMITED TO, REPRESENTATIONS, GUARANTEES, OR WARRANTIES OF MERCHANTABILITY, ACCURACY, QUALITY OF SERVICE OR RESULTS, AVAILABILITY, SATISFACTORY QUALITY, LACK OF VIRUSES, QUIET ENJOYMENT, FITNESS FOR A PARTICULAR PURPOSE AND NON-INFRINGEMENT AND ANY WARRANTIES ARISING FROM ANY COURSE OF DEALING, USAGE OR TRADE PRACTICE IN CONNECTION WITH SUCH PRODUCTS AND SERVICES. BUYER ACKNOWLEDGES THAT NEITHER UBIQUITI NETWORKS NOR ITS THIRD PARTY PROVIDERS CONTROL BUYER'S EQUIPMENT OR THE TRANSMISSION OF DATA OVER COMMUNICATIONS FACILITIES, INCLUDING THE INTERNET, AND THAT THE PRODUCTS AND SERVICES MAY BE SUBJECT TO LIMITATIONS, INTERRUPTIONS, DELAYS, CANCELLATIONS AND OTHER PROBLEMS INherent IN THE USE OF COMMUNICATIONS FACILITIES. UBIQUITI NETWORKS, ITS AFFILIATES AND ITS AND THEIR THIRD PARTY PROVIDERS ARE NOT RESPONSIBLE FOR ANY INTERRUPTIONS, DELAYS, CANCELLATIONS, DELIVERY FAILURES, DATA LOSS, CONTENT CORRUPTION, PACKET LOSS, OR OTHER DAMAGE RESULTING FROM ANY OF THE FOREGOING. In addition, UBIQUITI NETWORKS does not warrant that the operation of the Products will be error-free or that operation will be uninterrupted. In no event shall UBIQUITI NETWORKS be responsible for damages or claims of any nature or description relating to system performance, including coverage, buyer's selection of products (including the Products) for buyer's application and/or failure of products (including the Products) to meet government or regulatory requirements.

#### Limitation of Liability

EXCEPT TO THE EXTENT PROHIBITED BY LOCAL LAW, IN NO EVENT WILL UBIQUITI OR ITS SUBSIDIARIES, AFFILIATES OR SUPPLIERS BE LIABLE FOR DIRECT, SPECIAL, INCIDENTAL, CONSEQUENTIAL OR OTHER DAMAGES (INCLUDING LOST PROFIT, LOST DATA, OR DOWNTIME COSTS), ARISING OUT OF THE USE, INABILITY TO USE, OR THE RESULTS OF USE OF THE PRODUCT, WHETHER BASED IN WARRANTY, CONTRACT, TORT OR OTHER LEGAL THEORY, AND WHETHER OR NOT ADVISED OF THE POSSIBILITY OF SUCH DAMAGES.

#### Note

Some countries, states and provinces do not allow exclusions of implied warranties or conditions, so the above exclusion may not apply to you. You may have other rights that vary from country to country, state to state, or province to province. Some countries, states and provinces do not allow the exclusion or limitation of liability for incidental or consequential damages, so the above limitation may not apply to you. EXCEPT TO THE EXTENT ALLOWED BY LOCAL LAW, THESE WARRANTY TERMS DO NOT EXCLUDE, RESTRICT OR MODIFY, AND ARE IN ADDITION TO, THE MANDATORY STATUTORY RIGHTS APPLICABLE TO THE LICENSE OF ANY SOFTWARE (EMBEDDED IN THE PRODUCT) TO YOU. The United Nations Convention on Contracts for the International Sale of Goods shall not apply to any transactions regarding the sale of the Products.

#### Compliance

##### FCC

Changes or modifications not expressly approved by the party responsible for compliance could void the user's authority to operate the equipment.

This device complies with Part 15 of the FCC Rules. Operation is subject to the following two conditions.

1. This device may not cause harmful interference, and
2. This device must accept any interference received, including interference that may cause undesired operation.

This equipment has been tested and found to comply with the limits for a Class A digital device, pursuant to part 15 of the FCC Rules. These limits are designed to provide reasonable protection against harmful interference when the equipment is operated in a commercial environment. This equipment generates, uses, and can radiate radio frequency energy and, if not installed and used in accordance with the instruction manual, may cause harmful interference to radio communications. Operations of this equipment in a residential area is likely to cause harmful interference in which case the user will be required to correct the interference at his own expense.

This radio transmitter (FCC: SWX-UJAPACMPRO) has been approved by FCC to operate with the antenna types listed below with the maximum permissible gain and regulated antenna impedance for each antenna type indicated. Antenna types not included in this list, having a gain greater than the maximum gain indicated for that type, are strictly prohibited for use with this device.

Antenna Information: Dual-band antenna, Gain: 8 dBi

Industry Canada

CAN ICES-3(A)/NMB-3(A)

This Class A digital apparatus complies with Canadian ICES-003.

To reduce potential radio interference to other users, the antenna type and its gain should be so chosen that the equivalent isotropically radiated power (e.i.r.p.) is not more than that permitted for successful communication.

This device complies with Industry Canada licence-exempt RSS standard(s). Operation is subject to the following two conditions:

1. This device may not cause interference, and
2. This device must accept any interference, including interference that may cause undesired operation of the device.

This radio transmitter (IC-6545A-UAPACMPRO) has been approved by Industry Canada to operate with the antenna types listed below with the maximum permissible gain and required antenna impedance for each antenna type indicated. Antenna types not included in this list, having a gain greater than the maximum gain indicated for that type, are strictly prohibited for use with this device.

Antenna information: Dual-band antenna; Gain: 8 dBi

CAN ICES-3(A)/NMB-3(A)

Cet appareil numérique de la classe A est conforme à la norme NMB-003 du Canada.

Pour réduire le risque d'interférence aux autres utilisateurs, le type d'antenne et son gain doivent être choisis de façon que la puissance isotrope rayonnée équivalente (PIRE) ne dépasse pas ce qui est nécessaire pour une communication réussie.

Cet appareil est conforme à la norme RSS Industrie Canada exempts de licence normés. Son fonctionnement est soumis aux deux conditions suivantes:

1. Cet appareil ne peut pas provoquer d'interférences et
2. Cet appareil doit accepter toute interférence, y compris les interférences qui peuvent causer un mauvais fonctionnement du dispositif.

Cet émetteur radio (IC-6545A-UAPACMPRO) a été approuvé par Industrie Canada pour l'exploitation avec l'antenne types énumérés ci-dessus avec le gain maximal admissible et l'impédance de l'antenne pour chaque type d'antenne indiqué. Types d'antenne non inclus dans cette liste, ayant un gain supérieur au gain maximal indiqué pour ce type, sont strictement interdits pour une utilisation avec cet appareil.

Informations d'antenne: Antenne bi-bande; Gain: 8 dBi

#### RF Exposure Warning

The antennas used for this transmitter must be installed to provide a separation distance of at least 20 cm from all persons and must not be located or operating in conjunction with any other antenna or transmitter, except as listed for this product's certification.

Les antennes utilisées pour cet émetteur doit être installé pour fournir une distance de séparation d'au moins 20 cm de toutes les personnes et ne doit pas être situé ou opérant en conjonction avec une autre antenne ou un autre émetteur, sauf dans les cas énumérés à la certification de ce produit.

#### CE Marking

CE marking on this product represents the product is in compliance with all directives that are applicable to it.

#### Alert Sign (!) Follows CE Marking

Alert sign must be indicated if a restriction on use applied to the product and it must follow the CE marking.



### RoHS/WEEE Compliance Statement



#### English

European Directive 2012/19/EU requires that the equipment bearing this symbol on the product and/or its packaging must not be disposed of with unsorted municipal waste. The symbol indicates that this product should be disposed of separately from regular household waste streams. It is your responsibility to dispose of this and other electric and electronic equipment via designated collection facilities appointed by the government or local authorities. Correct disposal and recycling will help prevent potential negative consequences to the environment and human health. For more detailed information about the disposal of your old equipment, please contact your local authorities, waste disposal service, or the shop where you purchased the product.

#### Deutsch

Die Europäische Richtlinie 2012/19/EU verlangt, dass technische Ausrüstung, die direkt am Gerät und/oder an der Verpackung mit diesem Symbol versehen ist, nicht zusammen mit unsortiertem Gemeindeabfall entsorgt werden darf. Das Symbol weist darauf hin, dass das Produkt von regulärem Hausmüll getrennt entsorgt werden sollte. Es liegt in Ihrer Verantwortung, dieses Gerät und andere elektrische und elektronische Geräte über die dafür zuständigen und von der Regierung oder örtlichen Behörden dazu bestimmten Sammelstellen zu entsorgen. Ordnungsgemäßes Entsorgen und Recyceln trägt dazu bei, potentielle negative Folgen für Umwelt und die menschliche Gesundheit zu vermeiden. Wenn Sie weitere Informationen zur Entsorgung Ihrer Altgeräte benötigen, wenden Sie sich bitte an die örtlichen Behörden oder städtischen Entsorgungsdienste oder an den Händler, bei dem Sie das Produkt erworben haben.



#### Español

La Directiva 2012/19/UE exige que los equipos que lleven este símbolo en el propio aparato y/o en su embalaje no deben eliminarse junto con otros residuos urbanos no seleccionados. El símbolo indica que el producto en cuestión debe separarse de los residuos domésticos convencionales con vistas a su eliminación. Es responsabilidad suya desechar éste y cualesquiera otros aparatos eléctricos y electrónicos a través de los puntos de recogida que pone a su disposición el gobierno y las autoridades locales. Al desechar y reciclar correctamente estos aparatos estará contribuyendo a evitar posibles consecuencias negativas para el medio ambiente y la salud de las personas. Si desea obtener información más detallada sobre la eliminación segura de su aparato usado, consulte a las autoridades locales; al servicio de recogida y eliminación de residuos de su zona o pregunte en la tienda donde adquirió el producto.

#### Français

La directive européenne 2012/19/UE exige que l'équipement sur lequel est apposé ce symbole sur le produit et/ou son emballage ne soit pas jeté avec les autres ordures ménagères. Ce symbole indique que le produit doit être éliminé dans un circuit distinct de celui pour les déchets des ménages. Il est de votre responsabilité de jeter ce matériel ainsi que tout autre matériel électrique ou électronique par les moyens de collecte indiqués par le gouvernement et les pouvoirs publics des collectivités territoriales. L'élimination et le recyclage en bonne et due forme ont pour but de lutter contre l'impact néfaste potentiel de ce type de produits sur l'environnement et la santé publique. Pour plus d'informations sur le mode d'élimination de votre ancien équipement, veuillez prendre contact avec les pouvoirs publics locaux, le service de traitement des déchets, ou l'endroit où vous avez acheté le produit.

#### Italiano

La direttiva europea 2012/19/UE richiede che le apparecchiature contrassegnate con questo simbolo sul prodotto e/o sull'imballaggio non siano smaltite insieme ai rifiuti urbani non differenziati. Il simbolo indica che questo prodotto non deve essere smaltito insieme ai normali rifiuti domestici. È responsabilità del proprietario smaltire sia questi prodotti sia le altre apparecchiature elettriche ed elettroniche mediante le specifiche strutture di raccolta indicate dal governo o dagli enti pubblici locali. Il corretto smaltimento ed il riciclaggio aiuteranno a prevenire conseguenze potenzialmente negative per l'ambiente e per la salute dell'essere umano. Per ricevere informazioni più dettagliate circa lo smaltimento delle vecchie apparecchiature in Vostro possesso, Vi invitiamo a contattare gli enti pubblici di competenza, il servizio di smaltimento rifiuti o il negozio nel quale avete acquistato il prodotto.

## Declaration of Conformity

<b>Čeština</b> {Czech}	UBIQUITI NETWORKS tímto prohlašuje, že toto UBIQUITI NETWORKS zařízení, je ve shodě se základními požadavky a dalšími příslušnými ustanoveními směrnice 1999/5/EC.
<b>Dansk</b> {Danish}	Hermed, UBIQUITI NETWORKS, erklærer at denne UBIQUITI NETWORKS enhed, er i overensstemmelse med de væsentlige krav og øvrige relevante krav i direktiv 1999/5/EF.
<b>Nederlands</b> {Dutch}	Hierbij verklaart UBIQUITI NETWORKS, dat deze UBIQUITI NETWORKS apparaat, in overeenstemming is met de essentiële eisen en de andere relevante bepalingen van richtlijn 1999/5/EG.
<b>English</b>	Herby, UBIQUITI NETWORKS, declares that this UBIQUITI NETWORKS device, is in compliance with the essential requirements and other relevant provisions of Directive 1999/5/EC.
<b>Eesti</b> {Estonian}	Käesolevaga UBIQUITI NETWORKS kinnitab, et antud UBIQUITI NETWORKS seade, on vastavus põlvetele nõuetele ja teistele asjakohastele sätetele direktiivi 1999/5/EÜ.
<b>Suomi</b> {Finnish}	Täten UBIQUITI NETWORKS vakuuttaa, että tämä UBIQUITI NETWORKS-laitte, on yhdenmukainen olennaisien vaatimusten ja muiden sija koskevien direktiivin 1999/5/EC.
<b>Frangais</b> {French}	Par la présente UBIQUITI NETWORKS déclare, que l'appareil UBIQUITI NETWORKS, est conforme aux exigences essentielles et aux autres dispositions pertinentes de la directive 1999/5/CE.
<b>Deutsch</b> {German}	Hiermit erkläre UBIQUITI NETWORKS, dass sich dieses UBIQUITI NETWORKS Gerät, in Übereinstimmung mit den grundlegenden Anforderungen und den anderen relevanten Vorschriften der Richtlinie 1999/5/EG befindet.
<b>Ελληνικά</b> {Greek}	Από τού παρόντος, UBIQUITI NETWORKS, δηλώνει ότι αυτό η συσκευή UBIQUITI NETWORKS, είναι σε συμμόρφωση με τις βασικές απαιτήσεις και τις λοιπές σχετικές διατάξεις της οδηγίας 1999/5/ΕΚ.
<b>Magyar</b> {Hungarian}	Ezennel UBIQUITI NETWORKS kijelenti, hogy ez a UBIQUITI NETWORKS készülék megfelel az alapvető követelményeknek és más vonatkozó 1999/5/EK irányelv rendelkezésének.
<b>Islandska</b> {Icelandic}	Hér, UBIQUITI NETWORKS, því yfir að þetta UBIQUITI NETWORKS tæki er í samræmi við grunnkröfur og önnur viðeigandi ákvæði tilskipun 1999/5/EB.
<b>Italiano</b> {Italian}	Con la presente, UBIQUITI NETWORKS, dichiara che questo dispositivo UBIQUITI NETWORKS, è conforme ai requisiti essenziali ed alle altre disposizioni pertinenti della direttiva 1999/5/CE.
<b>Latvian</b> {Latvian}	Ar to, UBIQUITI NETWORKS, deklarē, ka UBIQUITI NETWORKS ierīce, ir saskaņā ar būtiskajām prasībām un citiem attiecīgām noteikumiem Direktīvā 1999/5/EC.

Lietuviškai (Lithuanian):	UBIQUITI NETWORKS deklaruoja, kad šis UBIQUITI NETWORKS' įrenginys atitinka esminius reikalavimus ir #itar 1999/5/CE Direktyvos nuostatas.
Maltili (Maltese):	Hasqerha k UBIQUITI NETWORKS, hidiqjara h dan, li inqwa UBIQUITI NETWORKS s'iswa konformi mar-rekwiżiti essenzjali ta' dispożizzjonijiet rilevanti oħrajn ta' Direktiva 1999/5/KE
Norsk (Norwegian):	Herjved UBIQUITI NETWORKS, erklærer at detene UBIQUITI NETWORKS enheten, er i samsvar med de grunnleggende kravene og andre relevante bestemmelser i direktiv 1999/5/EF.
Polski (Polish):	Niniejszym, Ubiquiti Networks, oświadcza, że urządzenie UBIQUITI NETWORKS, jest zgodny z zasadniczymi wymaganiami oraz pozostałymi stosownymi postanowieniami Dyrektywy 1999/5/WE.
Português (Portuguese):	UBIQUITI NETWORKS declara que este dispositivo UBIQUITI NETWORKS, está conforme com os requisitos essenciais e outras disposições da Directiva 1999/5/CE.
Română (Romanian):	Prin prezenta, UBIQUITI NETWORKS declară că acest dispozitiv UBIQUITI NETWORKS este în conformitate cu cerințele esențiale și alte prevederi relevante ale Directivei 1999/5/CE.
Slovensky (Slovak):	Týmto UBIQUITI NETWORKS, prehlasuje, že toto UBIQUITI NETWORKS zariadenie, je v súlade so základnými požiadavkami a ďalšími relevantnými ustanoveniami smernice 1999/5/ES.
Español (Spanish):	Por medio de la presente UBIQUITI NETWORKS declara que este dispositivo UBIQUITI NETWORKS, cumple con los requisitos esenciales y cualesquiera otras disposiciones aplicables o exigibles de la Directiva 1999/5/CE.
Svenska (Swedish):	Härmed UBIQUITI NETWORKS, intygar att denna UBIQUITI NETWORKS enhet är överensstämmande med de väsentliga föreskrifterna och övriga relevanta bestämmelserna i Europadirektiv 1999/5/EG.

Online Resources  
Support [help.ubuntu.com](http://help.ubuntu.com)  
Community [community.ubuntu.com](http://community.ubuntu.com)  
Downloads [downloads.ubuntu.com](http://downloads.ubuntu.com)



[www.ubuntu.com](http://www.ubuntu.com)

Ubuntu Linux and Netop are trademarks or registered trademarks of Canonical Ltd. and Ubuntu Linux. All other trademarks are the property of their respective owners.

14/01/2016